

599 FS Pin-Type Fork Positioner with Welded Forks

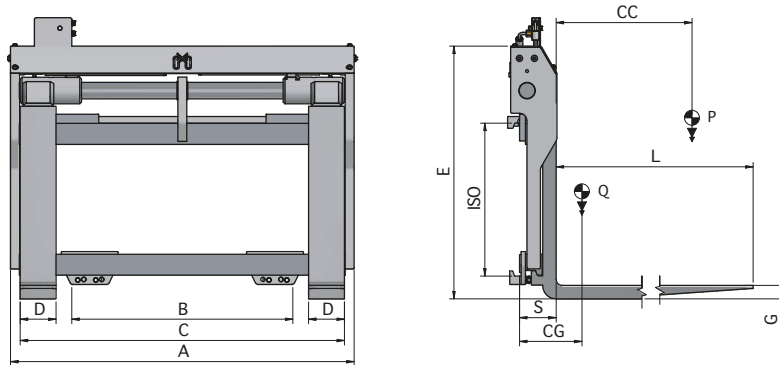

Hydraulic functions: 1 | Max working pressure: 110 Bar

Features:

- Differentiated Cylinders for a constant and synchronised movement of the forks.
- Sliding on the pin for particularly demanding use.
- Pressure Relief Valve.

Special Equipment:

- Special widths and/or openings.
- Custom made Forks.
- Load Backrest.
- Check valve for barrel grabbing.

Article	Attachment Capacity	Load Centre of Gravity	ISO	Carriage Width	Minimum Fork Carriage	Opening Range		Forks	Height	Thickness	Centre of Gravity	Weight
N°	P (kg)	CC (mm)	2328	A (mm)	B (mm)	C Min (mm)	C Max (mm)	DxGxL (mm)	E (mm)	S (mm)	CG (mm)	Q (kg)
18VFA2A0005	2500	500	2a	980	800	395	905	120X40X1200	730	104	223	243
18VFA2A0001	2500	500	2a	1040	860	395	965	120X40X1200	730	104	220	247
18VFA2A0011	2500	500	2a	1150	970	395	1075	120X40X1200	730	104	215	254
18VH23A0002	3000	500	3a	1150	970	465	1085	120X45X1200	840	122	208	319
18VLL3A0004	5000	500	3a	1250	1070	475	1155	150X50X1200	840	127	233	401
18VLL3A0005	5000	500	3a	1350	1170	475	1255	150X50X1200	840	127	230	410
18VLL3A0006	5000	500	3a	1550	1370	475	1455	150X50X1200	840	127	222	427

Oil flow rate	
ISO	(L/min)
	↑ ↓
2	15
3	20

↑ Opening
↓ Closing

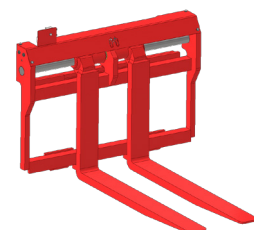

Please refer to our catalogue for further Special Equipment